

# Welcome to SSM St. Mary's Health Center

## TO REGISTER:

Registration locations are marked in red. If you have an appointment for any of the following services, please proceed directly to that department to register.

- Endoscopy (ground floor)
- Radiation Oncology (ground floor)
- St. Mary's Clinic (take clinic elevator from ground floor)
- Senior Care Center (first floor)
- Same Day Surgery (first floor)

Otherwise, proceed to the **West Entrance Outpatient Registration Desk** by taking the main elevators to the ground floor and proceeding down the hall to the right.

## TO VISIT A PATIENT:

Check-in at the **Information Desk** (first floor), then proceed to your patient's nursing floor from the **Main Elevators**. For floors marked East, take a left out of the elevators. Take a right for floors marked West or Southwest. Visitor amenities are marked in blue on the map.

- 2 East: Knee and Hip Center
- 2 West: Surgical Patients
- 3 East and 3 West: Medical Patients, ICU
- 4 East and 4 West: Telemetry/Cardiology Patients, ICU
- 5 East: Mother and Baby Unit
- 5 West: Labor and Delivery

## LOST?

Call (314) 768-8567 (8567 from a St. Mary's Health Center phone) for help, or stop by the **Information Desk** on the first floor.

*See the back of this map for information about parking and services located in our Medical Buildings*

## LEGEND

-  PUBLIC STAIRS
-  PUBLIC ELEVATORS
-  PUBLIC RESTROOMS
-  PUBLIC TELEPHONES

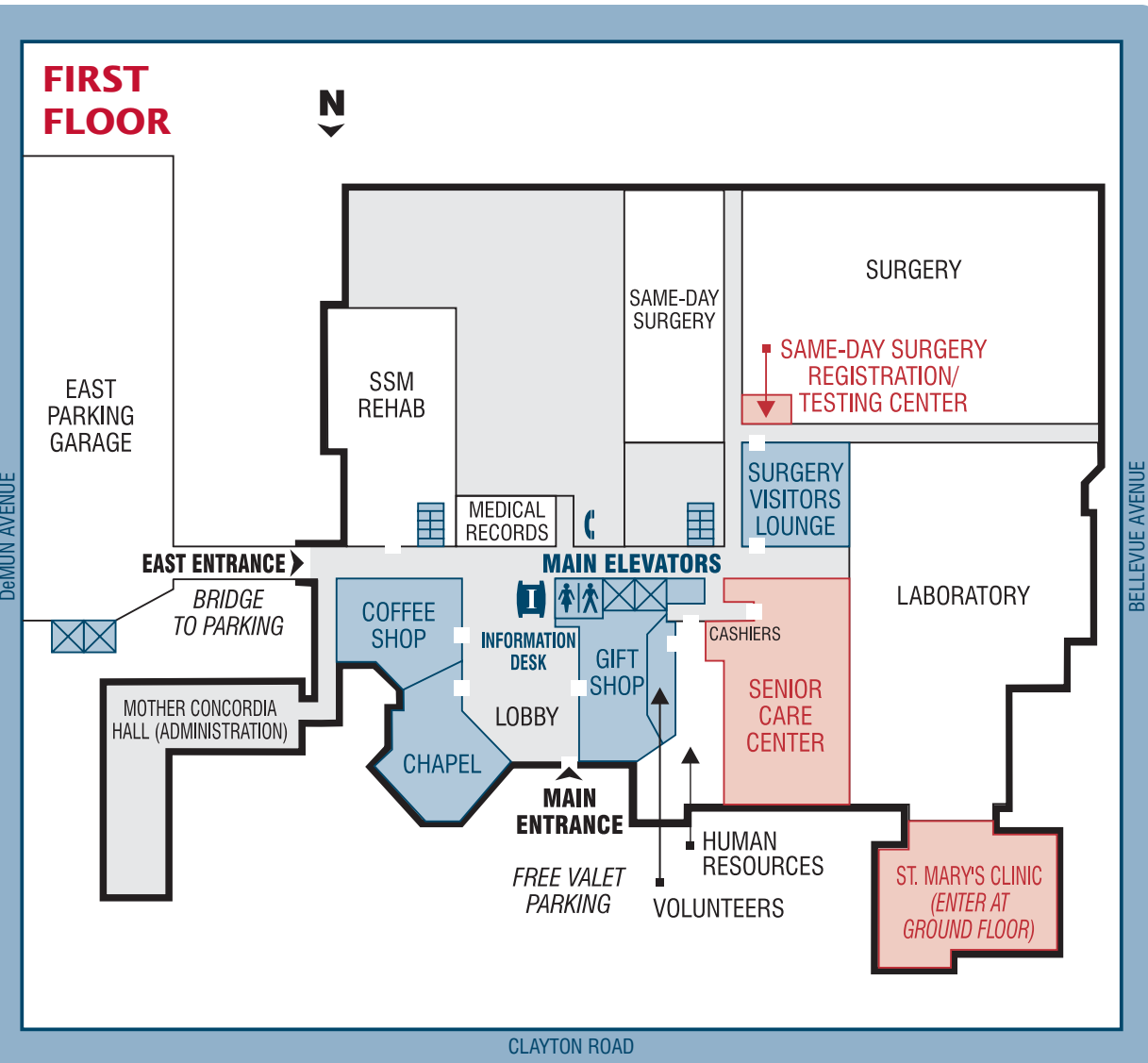
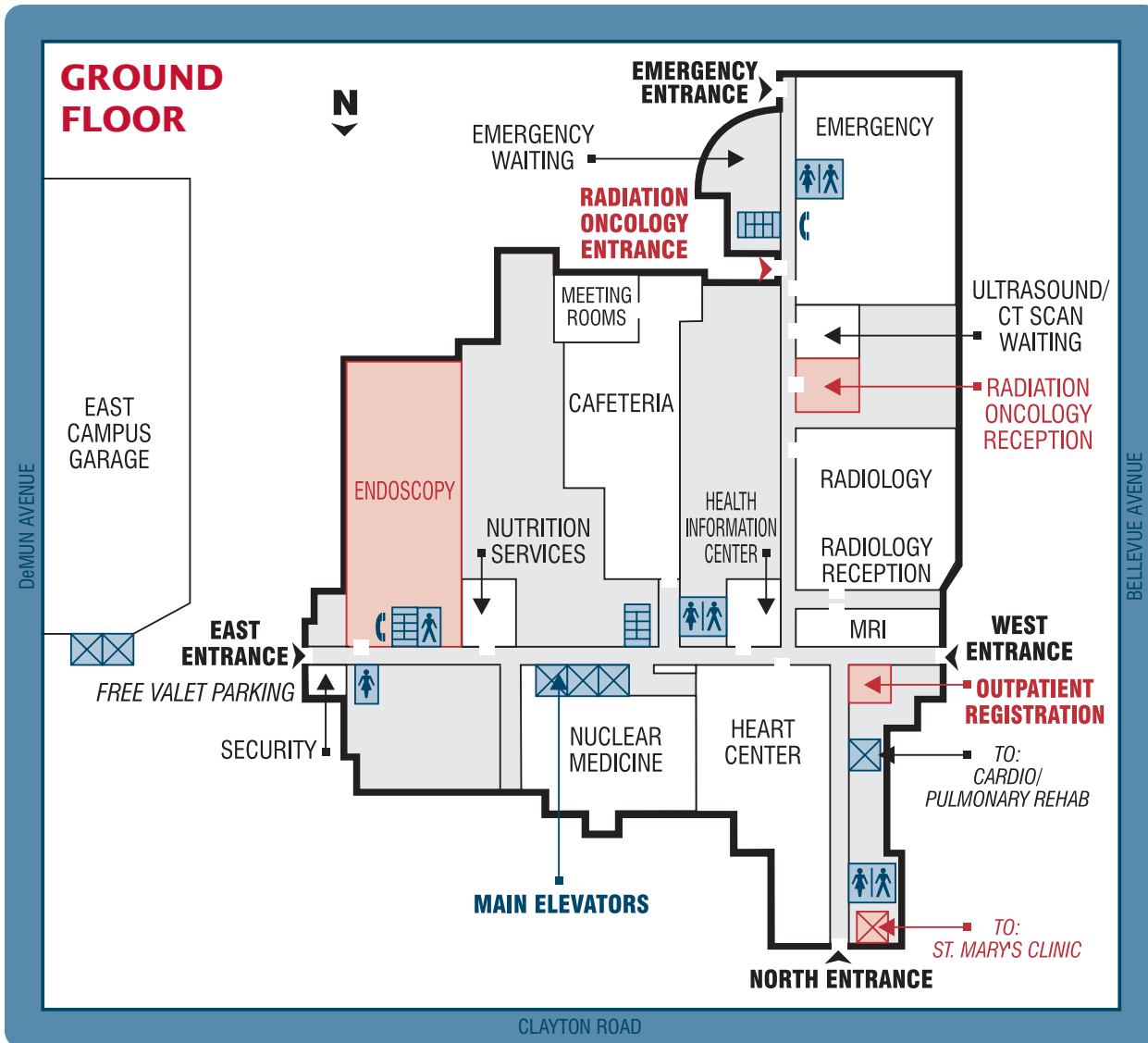

## SERVICES LOCATED IN BELLEVUE MEDICAL PLAZA

### Medical Building A

1027 Bellevue

#### Lower Level

- Transitional Care

#### Ground Floor

- Auditorium
- Outpatient Physical Therapy

#### First Floor

- Infusion Center

#### Second Floor

- Women's Well
- Lactation
- Baby Pagers
- Breast Pump Rentals
- Natural Family Planning
- Urogynecology
- Fetal Evaluation and Treatment Center

#### Third Floor

- Surgery Suites

#### Fourth Floor

- Behavioral Medicine

### Medical Building B

1031 Bellevue

- Women's Imaging Center
- Clayton Health Services West (lab/radiology)

### Medical Building C

1035 Bellevue

- Outpatient Pharmacy

### Medical Building D

6400 Clayton

- Clayton Health Services East (lab/radiology)

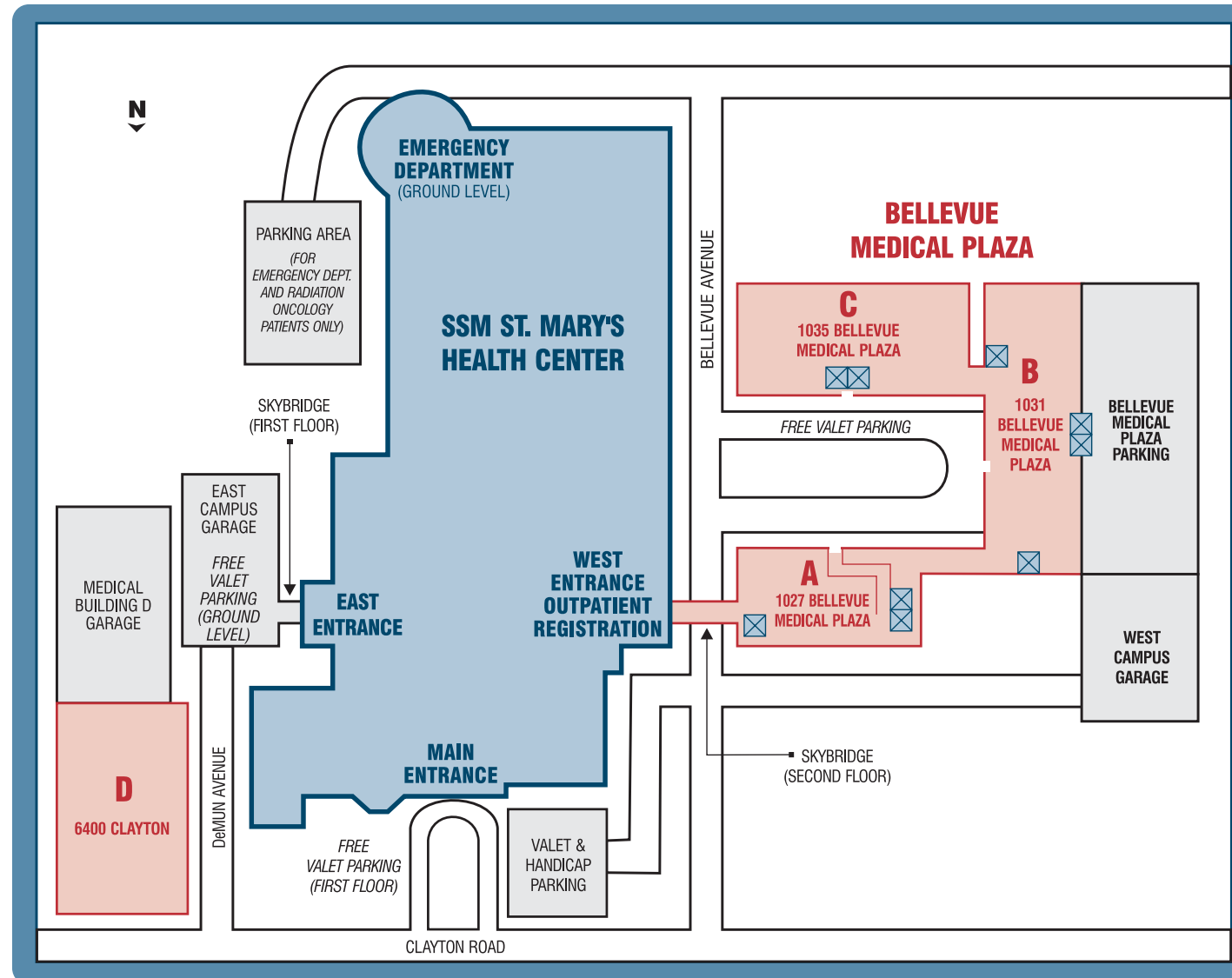

6420 Clayton Road  
 Richmond Heights, MO 63117  
 (314) 768-8000

SSM St. Mary's Health Center patrons, please park in the **East Campus Garage**. **Emergency Department** and **Radiation Oncology** patrons only may park in the parking lot east of Bellevue Ave. **Bellevue Medical Plaza** patrons please park in the **Bellevue Medical Plaza Parking**, except for **Behavioral Medicine** or **Surgical Suites** patrons, who should park in the **West Campus Garage**.

